

## \$339,900 - 131 Hayward Crescent, Edmonton

MLS® #E4442845

**\$339,900**

0 Bedroom, 0.00 Bathroom,  
Single Family on 0.00 Acres

Hodgson, Edmonton, AB

WANT TO BUILD YOUR DREAM HOME IN SW EDMONTON? A VERY RARE OPPORTUNITY ! 34 POCKET WALKOUT LOT available in HODGSON . Hodgson is a beautiful family community in SW Edmonton that has parks, walking trails & borders the ravine. Close to all amenities, Terwillegar Rec Centre, Shopping, Restaurants & Schools.

### Essential Information

MLS® #	E4442845
Price	\$339,900
Bathrooms	0.00
Acres	0.00
Type	Single Family
Sub-Type	Vacant Lot/Land
Status	Active

### Community Information

Address	131 Hayward Crescent
Area	Edmonton
Subdivision	Hodgson
City	Edmonton
County	ALBERTA
Province	AB
Postal Code	T6R 3G3

### Exterior

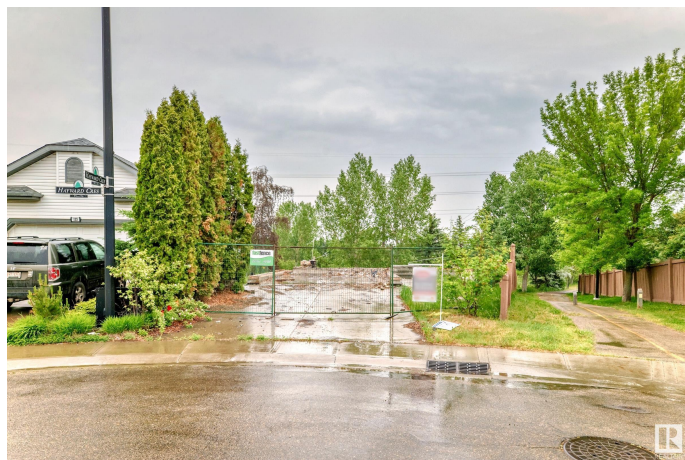

Exterior Features    See Remarks

**School Information**

Elementary	Riverbend Junior High scho
Middle	Riverbend Junior High scho
High	Lillian Osborne High Schoo

**Additional Information**

Date Listed	June 17th, 2025
Days on Market	8
Zoning	Zone 14

DATA IS DEEMED RELIABLE BUT IS NOT GUARANTEED ACCURATE BY THE REALTORS® ASSOCIATION OF EDMONTON. COPYRIGHT 2025 BY THE REALTORS® ASSOCIATION OF EDMONTON. ALL RIGHTS RESERVED.Trademarks are owned or controlled by the Canadian Real Estate Association (CREA) and identify real estate professionals who are members of CREA (REALTOR®, REALTORS®) and/or the quality of services they provide (MLS®, Multiple Listing Service®)

Listing information last updated on June 25th, 2025 at 11:48am MDT